

# Doodle SCRUB

Owner's  
Manual  
Original  
Instructions



## EBG SERIES SURFACE PREPARATION MACHINES

EBG-9



[WWW.SQUARESCRUB.COM](http://WWW.SQUARESCRUB.COM) / 800.557.6822

# Doodle Scrub BY SQUARE SCRUB

## Owner's Manual

---

### About your Doodle Scrub Floor Surface Preparation Machine

The Doodle Scrub offers a 1/4 hp, 4100 rpm motor, a heavy duty powder coated 10 gauge steel frame, and a two-position handle. The option to connect the handle on either the side of the machine or at the back offers the flexibility to adjust the machine to suit your needs. At 22 lbs, the Doodle Scrub offers nearly the same pounds per square inch as its parent machine, the EBG-20/C.

The Doodle Scrub is designed to go where larger machines can't. Cleaning stairs, around the toilet, under bathroom sinks is easy with the Doodle Scrub. This makes it the perfect companion to other EBG Series Floor Preparation Machines.

Please visit our website at [www.squarescrub.com](http://www.squarescrub.com) for informative videos and literature.

#### Contents

- Introduction
- Manual Conventions
- Safety / Important
- Machine Transport
- Operating Instructions
- Troubleshooting Guide
- Parts Breakdown
- Warranty Information
- Pad Information

#### Introduction

You are now the proud owner of an EBG-Series machine. This machine is a product of Square Scrub. It is made of fine materials and will give you many years of satisfactory service if maintained and used according to the guidelines in this owner's manual.

**Please read all Installation, Operation, and Safety Instructions before using this machine.**

**\*\*\*This product is for Industrial/Institutional/Commercial Use Only\*\*\***

#### **WARNING OF POTENTIAL INJURY! MOVING PARTS! UNPLUG BEFORE SERVICING!**

This product contains moving parts. To reduce the risk of injury, unplug before servicing.

#### **General Safety**

- This floor-finishing machine shall be grounded while in use to protect the operator from electric shock. The machine is provided with a three-conductor cord and a three-contact grounding type attachment plug to fit the proper grounding type receptacle. The green (or green and yellow) conductor in the cord is the grounding wire. Never connect this wire to anything other than the grounding pin of the attachment plug.

- This machine is for use on a nominal 120-volt circuit and has a grounding plug that resembles the plug in figure 1. Make sure that the machine is connected to an outlet having the same configuration as the plug. See figure 1 on page 2.

**No adapter should be used with this machine.**

# Maintenance Schedule

## Prior to using (daily)

- Check AC power cord. Do NOT operate equipment if AC power cord is cut, frayed or if ground is missing.
- Check grip face and driver pad : inspect for wear/debris. Replace as needed.

## After use (daily)

- Clean pad and base plate assembly : remove/replace pad as needed.
- Inspect grip face for wear. Remove debris between grip face and base plate.
- Wipe entire unit with damp microfiber cloth.
- Make certain a pad is placed on grip face.

## Weekly Preventive Maintenance

- Check grip face for wear.
- Use vacuum to clean away debris build-up around base plate.

## Annually

- Replace **ALL** isolators.
- Bearing Assembly Replacement\*

\*The Bearing assembly is considered to be a wear item. We recommend that the bearing assembly be replaced as needed. Unit will become noisy when bearing needs to be replaced.

\*\*\***NOTE:** Be sure to replace isolators when you replace the bearing.

\*\*\*figure 1

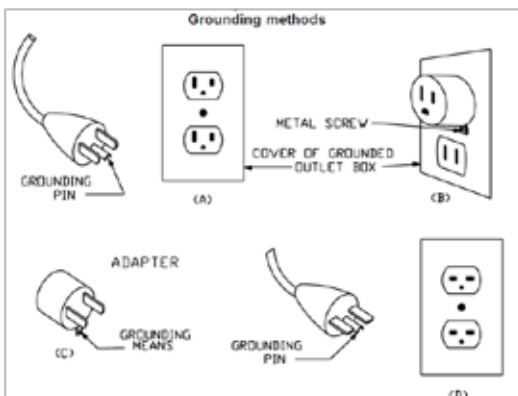

# Manual Conventions

**Danger:** Indicates an imminently hazardous situation which, if not avoided, may result in death or serious injury.

**Caution:** Indicates that machine or property damage could result if instructions are not followed.

**Note:** Provides helpful information. *Severe bodily injury or death can occur to you or other personnel if warnings found on this machine or in this owner's manual are ignored. Read and observe all statements and instructions found on the machine and in the owner's manual.*

---

## Who to call for assistance

If you work with a Square Scrub-authorized distributor, contact them for assistance.

If any contents of the box are missing, contact your Square Scrub-authorized dealer. If you purchased your machine directly from Square Scrub, contact Square Scrub at 1.800.557.6822 for service in the United States and Canada. For worldwide service, call Square Scrub directly at 870.930.9898. Make sure you have the machine's serial number, located on the handle of the machine, when you call.

## Liability statement

This Square Scrub product has been built to the highest industry standards. Please note and heed the WARNING and caution labels that have been placed on the equipment and in this manual for your safety. PLEASE DO NOT ATTEMPT TO OPERATE OR REPAIR THIS EQUIPMENT WITHOUT ADEQUATE TRAINING. ANY USE, OPERATION OR REPAIR IN CONTRAVENTION OF THIS DOCUMENT IS AT YOUR OWN RISK. BY ACCEPTANCE OF THIS SYSTEM YOU HEREBY ASSUME ALL LIABILITY CONSEQUENT TO YOUR USE OR MISUSE OF THIS EQUIPMENT. SQUARE SCRUB SHALL NOT BE LIABLE FOR ANY INCIDENTAL, INDIRECT, SPECIAL OR CONSEQUENTIAL DAMAGE OF ANY KIND.

Equipment specifications, applications and options are subject to change at the sole discretion of Square Scrub without notice.

## Safety

All Square Scrub products are built to strict safety and reliability specifications in accordance with industry standards. Therefore, safety issues pertaining to operation and repair of Square Scrub equipment are primarily environmental and human interface. The following basic safety tips are given to ensure safe installation, operation and maintenance of Square Scrub.

# Important

- Caution - This machine is intended for indoor use only.
- Caution - This machine is to be stored indoors only.
- Never leave the machine unattended while power cord is connected.
- Do not operate this machine while under the influence of alcohol or other drugs.
- Never allow children under age 18 to operate this machine.
- Unplug machine from power source before changing pad.
- Always wear personal protective equipment (PPE) when operating this machine.
- Never inhale dust created by the use of this machine. Any modifications to this machine may result in damage to the machine or injury to the operator or others nearby. Alterations to the machine will also void any and all warranty and liabilities.
- Sanding wood decks is not recommended by Square Scrub due to uneven surfaces which could lead to damage to the machine. Some pressure treated wood found in decking contains arsenic that, when sanded, will create hazardous dust. Square Scrub assumes no liability if the machine is used on decks, and damage caused from sanding pressure treated wood will not be warranted.
- Do not operate this machine around fuels, solvents, flammable floor finishes, thinners, wood particulate or any flammable materials. Cigarette lighters, pilot lights, electrical sparks and all other sources of ignition should be extinguished or avoided. Work areas should be well ventilated.
- Keep the power cord clear of the pad. Always lift the cord over the machine. Do not pull on the power cord in an attempt to move the machine. This could result in electrocution. Operating this machine with a damaged power cord could lead to electrocution or fire. Cord should remain clear of moving parts during operation. Never use the cord to navigate the machine. If the supply cord is damaged, it must be replaced by the manufacturer, its service agent or similarly qualified persons in order to avoid a hazard.
- Servicing this machine while still connected to a power source could lead to electrocution or fire. Before performing machine service or maintenance, disconnect the machine from its power source.
- Do not use machine if it has been sprayed with water or left out in the rain. This could result in a shock injury or electrocution.
- Keep feet, hands, and loose clothing away from any moving parts on the machine to avoid injury. Disconnect power cord before changing the pad or when servicing. Damage can occur to the machine or to other property if instructions in the owner's manual are not followed.
- This appliance is not intended for use by persons (including children) with reduced physical, sensory or mental capabilities, or lack of experience and knowledge, unless they have been given supervision or instruction concerning use of the appliance by a person responsible for their safety.



**PPE Equipment**

**Warning: This appliance is not suitable for picking up hazardous dust.**

## Transport of Machine

To transport this machine, the following procedure is advised:

- Unplug machine from power source.
- Always leave a pad on the machine to protect the grip face from damage in transport and storage.
- Secure machine when transporting in a vehicle to prevent movement.
- **NEVER PICK THE DOODLE SCRUB UP BY THE HANDLE ALONE!** Always pick the Doodle Scrub EBG-9 up with one hand on the handle and the other hand picking up the base. Failure to do so could possibly damage or ruin your machine.

## Operating Instructions

1. Move machine to work location. Never operate, transport, or store the machine without a pad to protect the grip face.
2. Affix the handle clip onto either of the two provided base clips.
3. Plug machine into grounded power outlet.
4. Hold the machine's handle with one hand while gently pressing the switch on the top of the handle with the other hand.
5. Begin moving the machine over the floor in either a mop-like motion or along edges.
6. Continue moving the machine over the selected surface, checking your pad every 15 to 30 minutes (depending on pad in use) to maintain optimum performance.

## Airborne Noise and Vibration Emissions

<b><u>Sound Power Level:</u></b>	<b><u>Vibration Total at Base:</u></b>
<b>120V:</b> Under 57 dBA	<b>120V:</b> Avg. 6.5 mm/s <sup>2</sup> , max at 6.9 mm/s <sup>2</sup>
<b>240V:</b> Under 57 dBA	<b>240V:</b> Avg. 5.8 mm/s <sup>2</sup> , max at 6.0 mm/s <sup>2</sup>

## Important HANDLE ATTACHMENT

The Doodle Scrub EBG-9 comes with two different ways of connecting the handle to the base. It is extremely important that you connect the handle correctly to the base or else you run the risk of excessive noise and rattle. Figure 2 and figure 3 shows the incorrect and correct way to attach the handle to the Doodle Scrub EBG-9.

**\*\*\*figure 2**  
**Incorrect** way  
of attaching handle to  
the Doodle Scrub base.



**\*\*\*figure 3**  
**Correct** way  
of attaching handle to  
the Doodle Scrub base.



# Troubleshooting

Problem	Cause	Action
<p><b>Unit runs correctly but stops. It works fine after 3-10 minutes</b></p>	<p>Incorrect pad is being used. Only use pads recommended by Square Scrub. Pads are not to exceed "5.25"x"10.5".</p> <p>SS P0511BLU - Driver Pad            SS P0511DRIVER - Thin Pad            SS P0511SHO - Wet Strip Pad            SS P0511SQP - Dry Prep Pad            SS P0511WHT - Thick Pad            SS P0511XTR - Dry Erase Pad            SS P0511TGB - Blue Tile &amp; Grout Pad</p> <p>Maximum Wet Weight: 5oz.</p> <p>***<b>NOTE: DO NOT USE GREEN TILE AND GROUT PAD ON THE EBG-9 DOODLE SCRUB.</b></p>	<p>Use correct pad. If problem continues contact your nearest Square Scrub Dealer.</p>
<p><b>Machine will not start</b></p>	<p>Not Connected to power source            Voltage too low            Defective switch</p>	<p>Check power source connection and lighted plug            Have electrician check outlet            Contact Square Scrub dealer</p>
<p><b>Runs erratically</b></p>	<p>Low voltage from excessive length or undersized extension cord            Defective start switch            Defective motor low voltage</p>	<p>Use 10 gauge extension cord            Not more than 25' long            Contact Square Scrub dealer            Contact Square Scrub dealer</p>
<p><b>Fuse/Circuit Breaker Trips</b></p>	<p>Low voltage            Low input volts</p>	<p>Allow the motor to cool.            Eliminate extension cord.            Locate power cord closer to work site.            Have voltage checked by electrician.</p>
<p><b>Machine pulls hard to one side</b></p> <p><b>Note:</b> The rubber isolators on the EBG are considered wear items. It is recommended to replace the entire set of all four isolators once per year (or sooner under heavy use) to prevent failure and damage to the machine.</p>	<p>Worn Pad            Rubber isolators are worn out</p>	<p>Rotate pad 180 degrees            Flip pad over            Replace Pad            Replace isolators</p>
<p><b>Machine is noticeably louder than it was when originally purchased</b></p>	<p>Rubber isolators worn</p>	<p>Replace isolators</p>



## Doodle Scrub 1 Year Limited Warranty on parts and 90 days Limited Warranty on Labor

### General

This Square Scrub EBG-9 Doodle Scrub Floor Preparation Machine is warranted to be free from defects in materials and workmanship under normal use and service for a period of one year on machine handle and base when operated and maintained in accordance with Square Scrub Maintenance and Operating Instructions. The warranty will commence on the purchase date by the original end user from an authorized Square Scrub dealer and is subject to proof of purchase. If proof of purchase cannot be provided, the warranty shall begin from the date of shipment to an authorized Square Scrub dealer. Parts replaced or repaired under warranty are guaranteed for the remainder of the original warranty period. The warranty period is subject to the conditions stated below.

Labor to repair the unit is also included for the first 90 days from date of original purchase. Unit must be returned to Square Scrub for all repairs other than the handle switch. End user must ship the unit to Square Scrub at their expenses. Unit will be repaired or replaced and returned to the end user or the authorized Square Scrub dealer by normal ground shipping method at Square Scrub's expense. Square Scrub is not responsible for lost time involved in the repair time.

### Disqualifications

This warranty shall not apply to repairs resulting from accidents or misuse, damage in transit, overloading the capacity of the machine, damage resulting from lack of proper maintenance or care as described in the Maintenance Schedule and General Operating Instructions listed in the Owner's Manual. Minor adjustments, not related to the replacement of parts, are not covered. Repairs or alterations made by an organization other than the factory or an Authorized Service Center are not covered and will void warranty as it relates to the parts or systems repaired or altered by the non-authorized organization.

### Product Exceptions & Exclusions Wear Items

- Machine Cord
- Blue Driver Pad (shipped with machine)
- Grip Face
- Cushion hand grip
- Rubber Isolators
- Eccentric Assembly (includes bearing)

If a difficulty develops with the product, contact your local Square Scrub dealer or call Square Scrub at 800.557.6822. Only Square Scrub can authorize repairs under warranty. Square Scrub may elect to require the return of components to validate a claim. Any defective part to be returned must be shipped freight prepaid to an authorized Square Scrub Dealer/Service Center or to the Square Scrub factory. Travel time and mileage is not covered on any repairs.

Square Scrub's liability under this warranty is limited to repair of the product and/or replacement of parts and is given to purchaser in lieu of all other remedies, including INCIDENTAL AND CONSEQUENTIAL DAMAGES. THERE ARE NO EXPRESS WARRANTIES OTHER THAN THOSE SPECIFIED HEREIN. THERE ARE NO WARRANTIES WHICH EXTEND BEYOND THE DESCRIPTION OF THE FACE HEREOF. NO WARRANTIES, INCLUDING BUT NOT LIMITED TO WARRANTY OF MERCHANTABILITY, SHALL BE IMPLIED.

Please register your machine on our website within thirty (30) days of purchase to assist Square Scrub in providing the performance you expect from your new floor machine.

Repairs after the first 90 days of the warranty period but still during the first 12 months will be done for \$69 to cover labor and Square Scrub will prepay the shipping to return the Doodle Scrub if it is an under warranty repair.

Repairs after the first 12 months will be done for \$69 flat fee plus the cost of parts and shipping.

Square Scrub

800-557-6822

[www.squarescrub.com](http://www.squarescrub.com)

**Machine Serial #:** \_\_\_\_\_

**Date of Purchase:** \_\_\_\_\_

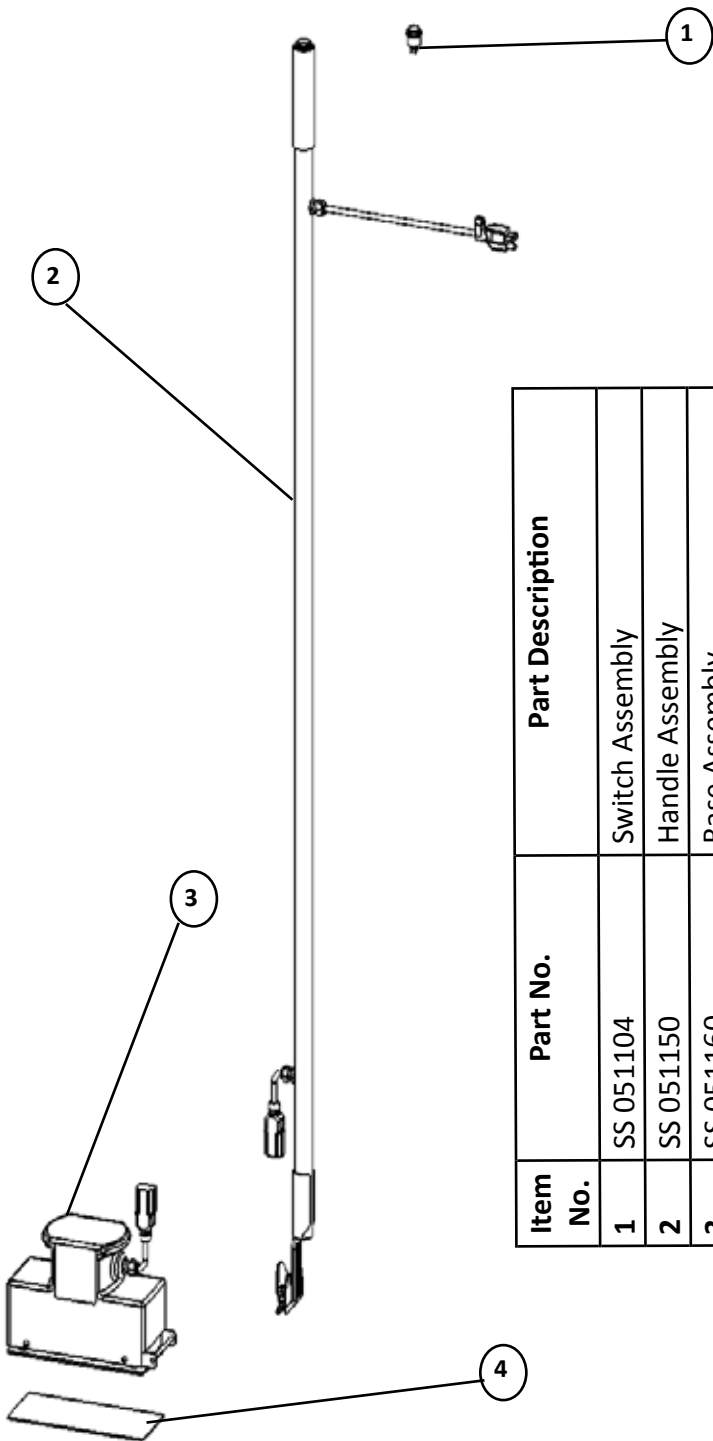

Item No.	Part No.	Part Description
1	SS 051104	Switch Assembly
2	SS 051150	Handle Assembly
3	SS 051160	Base Assembly
4	SS 051103	Grip Face

# Doodle Scrub Pad Ordering Information

## **Blue Tile and Grout Pad \* SS P0511TGB \* 4.75x10**

Our Tile and Grout pad is best on grouted tile floors, but can be used very effectively on terrazzo, poured non-slip, concrete and other uneven floors. Use wet on several surfaces.

Sold Individually

## **White Pad \* SS P0511WHT \* 5.25x10.5**

The White pad is used as a light duty polish pad. The 1" thick pad is used without a driver pad and is great for spreading chemicals while buffing.

16/cs

## **Xtreme Sponge \* SS P0511XTR \* 5.25x10.5**

Use the Xtreme Sponge to remove scuff marks on VCT or bathroom tile. A little water and this melamine pad deep cleans and restores shine between refinishing jobs. Use wet on VCT and bathroom tile.

5/cs

## **SHO Pad \* SS P0511SHO \* 5.25x10.5**

The SHO pad should be used only for the heaviest of chemical stripping jobs. Extremely abrasive and heavy, dense fibers. Best when dirt and buildup are severe. Use wet on VCT and tile. 20/cs

## **Blue Driver Pad \* SS P0511BLU \* 5.25x10.5**

This medium to heavy duty Blue pad can be used for heavier cleaning and buffing situations but primarily used as a spacer pad. Always check spacer and driver pads frequently for wear and replace as needed! Use wet or dry on VCT and tile. Can be used for heavier cleaning and buffing situations.

18/cs

## **SQP Pad \* SS P0511SQP \* 5.25x10.5**

SQP is a thin pad designed to remove floor finish without chemicals. Remove several layers of acrylic finish to prep for recoating. Use dry or wet on VCT and tile.

60/cs

## **White Driver Pad \* SS P0511DRIVER \* 5.25x10.5**

The Driver pad is designed to provide a spacer between your sandpaper and the machine. Just 1/4" thick, Use this pad with Sandpaper and Resin diamonds. Always check spacer and driver pads frequently for wear and replace as needed! Change pad often to protect floor.

48/cs

# Doodle SCRUB

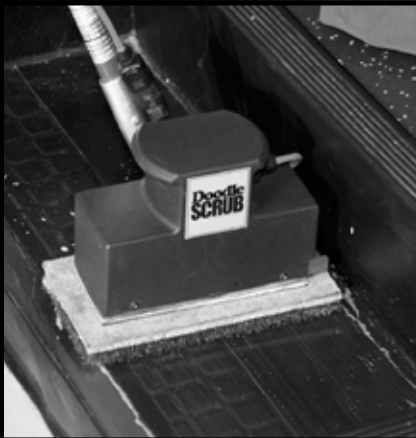

**Register your  
Square Scrub Product:**

**Online**

<http://www.squarescrub.com>



**American Made**