

ITEM NO.	PART NO.	DESCRIPTION	QTY.
1	H296	guard, cooling fan, wire	3
2	H343	screw, #10 x 5/8" hex head, zinc	8
3	G131	connector, cord lock	2
4	E550	power cord, pigtail, 30", 12/3, yel	2
5	H220	fitting, strain relief, cord	2
6	H221	nut, lock, 1/2" steel	2
7	H219	cap, axle, 1/2"	2
8	H251	wheel, 12"	2
9	H254	washer, axle, cut 1/2" id	4
10	H371	axle, 1/2" x 18-1/2", sp, breeze	1
11	P731	base, speedster	1
12	H770	bolt, 1/4-20 x 1/2" serrated hex flange, zinc	8
13	H211	washer, 1/4" id x 1" od, flat, s/s	8
14	H666	caster, 5"	2
15	H342	bolt, 1/4-20 x 1" hex head, s/s	8
16	H210	washer, 1/4" flat, s/s	19
17	H213	washer, 1/4" lock, s/s	4
18	H216	nut, lock, 1/4-20, nylon insert, s/s	13
19	H485	handle, breeze	2
20	C317	fan, cooling, 115V	1
21	H206	screw, #10-32 x 5/8" hex head, zinc	4
22	C322A	regulator, 200 psi	1
23	PH715	sol hose, kuriyama, 3/8"	1
24	B235	adapter, brass, 3/8" barb x 1/4" fsw	2
25	G059	exhaust boot, plastisol	2
26	H217	clamp, hose, 2-1/4 DIA	3
27	H768	bolt, 1/4-20 x 3/4" serrated hex flange, zinc	11
28	C310	vac motor, 2 stage HP, 115V, tangential	2
29	G004	gasket, vacuum motor	2
30	PH628	vac hose, 2", wire reinforced	1
31	H544	cuff, 2"	1
32	P750	manifold, dual vac, parallel	1
33	H500	vac support, 2 stage, 3-1/8"	6
34	H201	bolt, 1/4-20 x 1/2" hex head, zinc	8
35	H601	plate, manifold, parallel	1
36	E574	Thermostat, 310°F ± 10°F, Manual, 1/4"	2
37	H274	screw, #6 x 3/16, phil pan head, self-tapping	10
38	E573	Thermostat, 200°, Auto, 1/4"	2
39	E519	heating rod, 1000W, 115V	2
40	H230	screw, 10-32 x 1/2 phil pan	2
41	H273	nut, kep, #10-32 zinc	6
42	H528	bracket, heater mounting, dual	1
43	H903A	heater, aluminum cast, single w/wrap & drilled holes	2
44	B103	elbow, brass, 90 deg, 1/4" mpt x 1/4" fpt	8
45	AH156	hose, 3/8" x 6", (OAL), f x fsw, surge, 1600psi	1
46	AH105	hose, 3/8" x 17-1/2", (OAL), f x -fsw, surge, 1600psi	3
47	B106	nipple, brass, 1/4" x close	4
48	C322	pump, 200psi, bypass, 115V	1
49	H222	screw, #10-32 x 1-1/4" phil pan head, zinc	4
50	B127	plug, brass, 1/4" mpt, hex	1
51	H902	valve, prime, high pressure	1
52	B241	adapter, brass, 3/8" barb x 1/4" mpt	1
53	PH715	sol hose, kuriyama, 3/8"	1
54	H347	clamp, hose, 5/16-29/32	8

ITEM NO.	PART NO.	DESCRIPTION	QTY.
55	B136	elbow, brass, 90 deg, 1/4" mpt x 1/4" mpt	1
56	B644	adapter, brass, 1/2" barb x 1/4" mpt	1
57	PH615	sol hose, 1/2" kuri 100psi	1
58	B175	filter, cup, in-line	1
59	PH615	sol hose, 1/2" kuri 100psi	1
60	B160	adapter, brass, 1/2" barb x 3/8" fsw, ball end	1
61	AH103	hose, 3/8" x 10", (OAL), f x fsw, surge, 1600psi	1
62	B113	tee, brass, 1/4" fpt	1
63	P732	sol tank, speedster	1
64	H390A	bracket, "L" (all extracters)	2
65	H203	bolt, 1/4-20 x 1-1/4" hex head	2
66	G052	washer, buna 1-1/8" od x 3/16" id	6
67	H215	nut, hex, 1/4-20 s/s	2
68	H212	washer, 9/16" id x 1" od, flat, s/s	8
69	H413	washer, nylon, 9/16" id x 1-1/16" od x .031	2
70	B111	adapter, brass, extender, 1/4" mpt x 1/4" fpt, hex	3
71	B102	qd, brass, 1/4" f	1
72	B107	nipple, brass, 1/4" m, hex	1
73	B119A	filter, strainer, 1/2"	1
74	B210	bushing, brass, 1/2" mpt x 3/8" fpt, hex	1
75	H299	washer, 11/16" id x 1-1/2" od x .075, s/s	5
76	B216	nipple, brass, 3/8" x close	1
77	B186	elbow, brass, 90 deg, 3/8" mpt x 3/8" fmpt	1
78	H316	bolt, 1/4-20 x 1-1/2" hex head, s/s	2
79	H378	bracket, front hinge, sp/fb	1
80	H922	knob, thumb screw, for bracket	2
81	H307	1/4 ext tooth l/w steel zinc	2
82	H912	bracket, rear, fb/spy	1
83	P733	vac tank, speedster	1
84	H225	valve, drain, 1-1/2"	1
85	H226	spout, drain, 45 degree	1
86	G002	gasket, 2" inlet polyethylene, 3" OD 2.35" ID	2
87	P684	adaptor, pvc 2, fmsl x fmsl	1
88	P682	pipe, pvc, 2"	1
89	H490	float, 2", ball style	1
90	P726	elbow, 2" float	1
91	H304	screw, #8 x 5/8 phil oval, s/s	6
92	G090	lid, vac tank, black, 7"	1
93	G091	gasket, 7", vac lid	1
94	A926	elbow, inlet assembly 2"	1
95	G083	gasket, 2" inlet	1
96	P685	inlet, 2"	2
97	H612	washer, #8 flat, s/s	2
98	H246	screw, #8-32 x 3/8" SHCS, alloy	3
99	E511	light, red, 250v	2
100	E516	switch, rocker, 3 position	1
101	E515	switch, rocker, 2 position	3
102	E512B	light, indicator, 125v (amber)	1
103	H348	plate, switch, sp, 4 hole	1

ITEMS NOT SHOWN:

PART NO.	DESCRIPTION	QTY.
E530	power cord, ext, 50', 12/3 yel	2
G010	filter, bag, vac tank	1
G085	gasket, strip, 3/4" x 36" X 1/8"	2

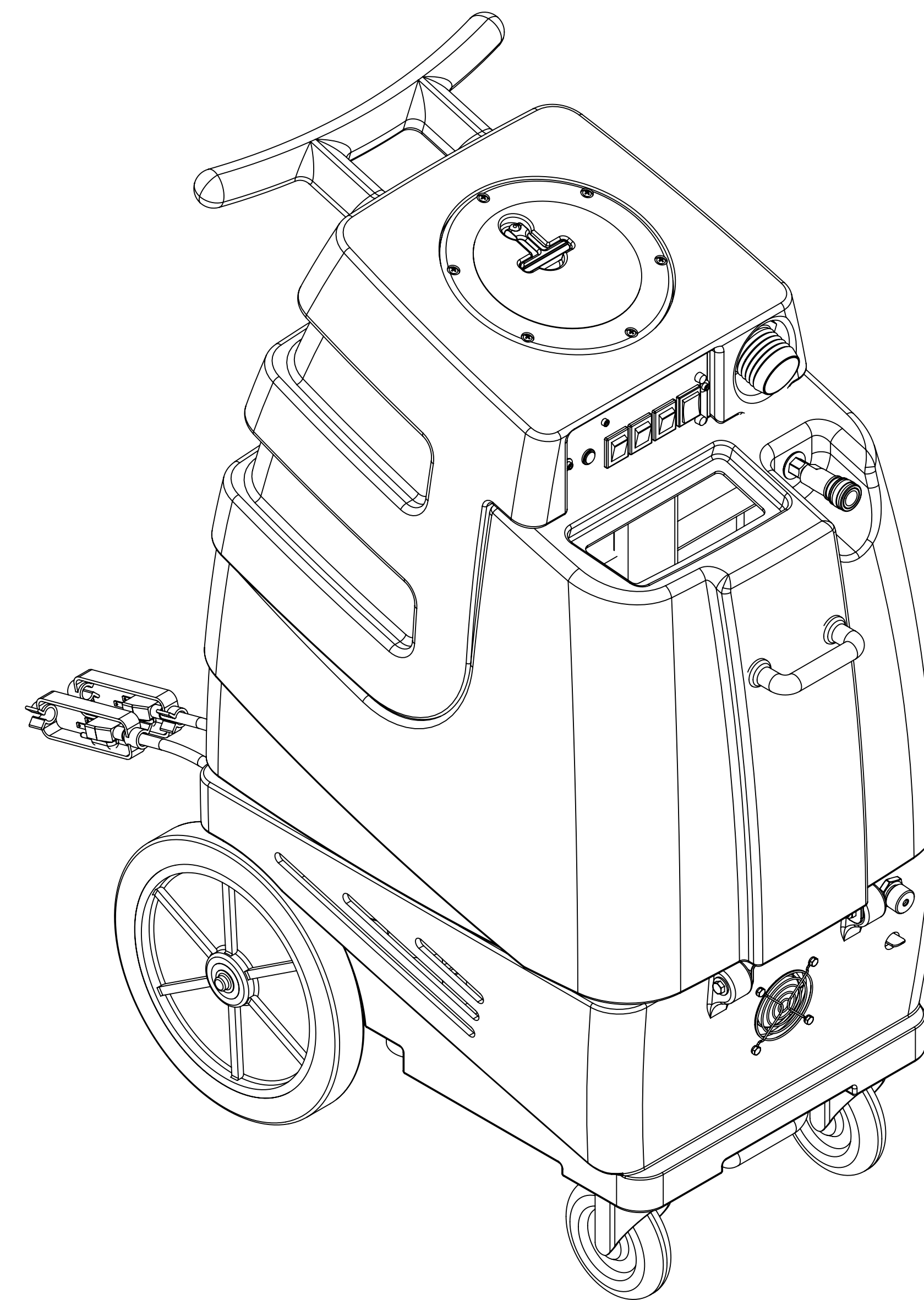

NAME	DATE	MYTEE PRODUCTS, INC.	
V. LaBarbera	4/06	888-679-1191	
CHECKED		TITLE: Speedster, 1001DX-200	
<small>PROPRIETARY AND CONFIDENTIAL THE INFORMATION CONTAINED IN THIS DRAWING IS THE SOLE PROPERTY OF MYTEE PRODUCTS, INC. ANY REPRODUCTION IN PART OR AS A WHOLE WITHOUT THE WRITTEN PERMISSION OF MYTEE PRODUCTS, INC. IS PROHIBITED.</small>		SIZE DWG. NO. REV <b>D</b> 1001DX-200 <b>0D</b>	SCALE: 1:4 DO NOT SCALE DRAWING SHEET 1 OF 2

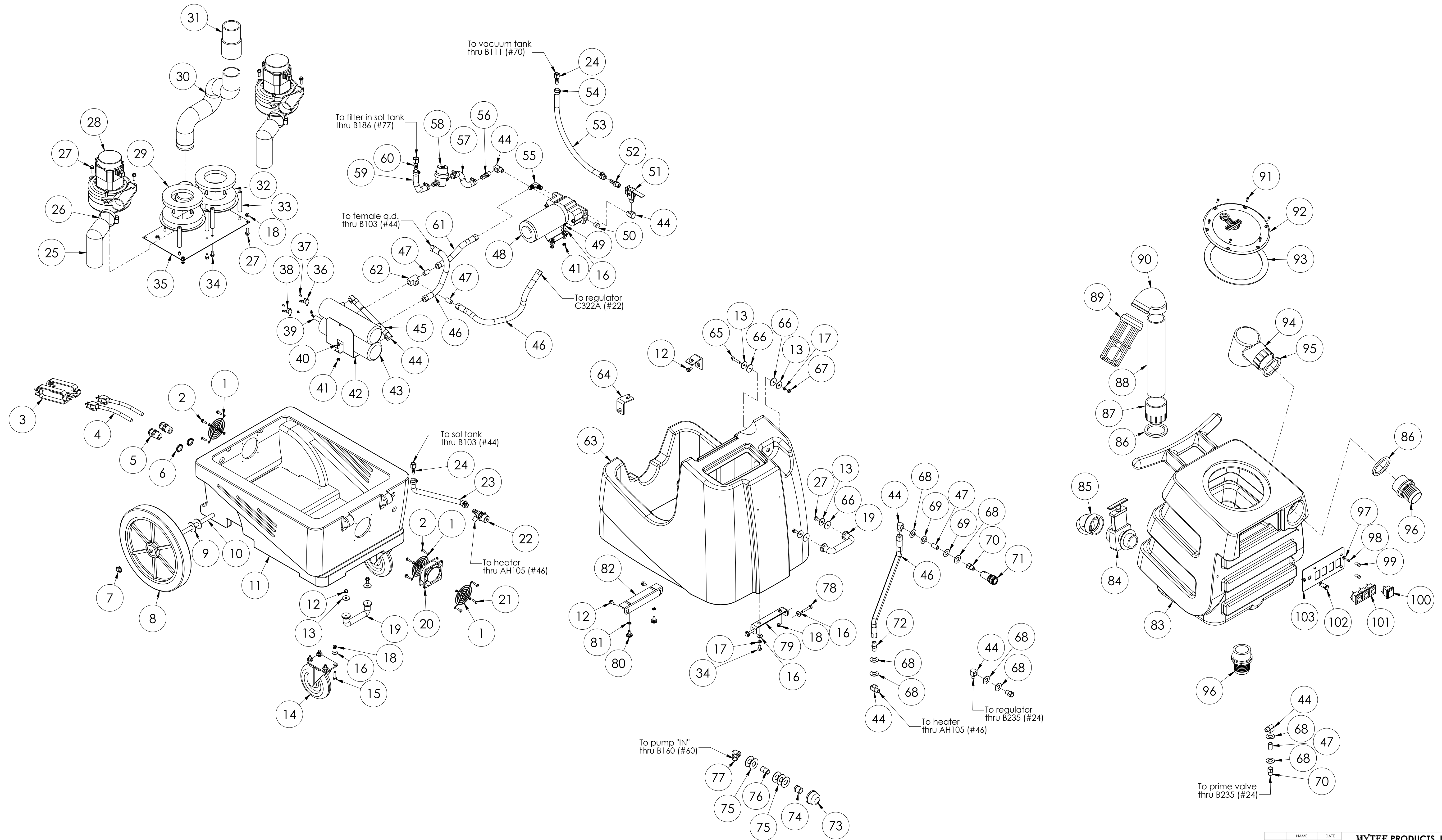

NAME	DATE	MYTEE PRODUCTS, INC. 850-679-1191
V. LaBarbera	4/06	
TITLE:	Speedster, 1001DX-200	
SIZE	DWG. NO.	REV
D	1001DX-200	0D
SCALE: 1:6	DO NOT SCALE DRAWING	SHEET 2 OF 2