



DESCRIPTION	PAGE
Motor top, EWD 315, EWD 320, EWD 215, EWD 260.	2
Containers, EWD 315, EWD 320, EWD 215, EWD 260.	4
Wheels	6
Nozzles, tubes and hoses	8
Filter and dustbags	10
Wiring diagram	12

WHEN ORDERING PARTS

- * Use the digit numbers from the "Part. No." columns in this parts list.
- * Specify the serial number of the machine.
- * Use the space below to record the model and serial number for future reference.

Model _____ Serial no. _____

Model _____ Serial no. _____

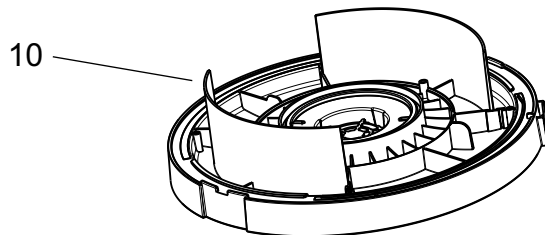
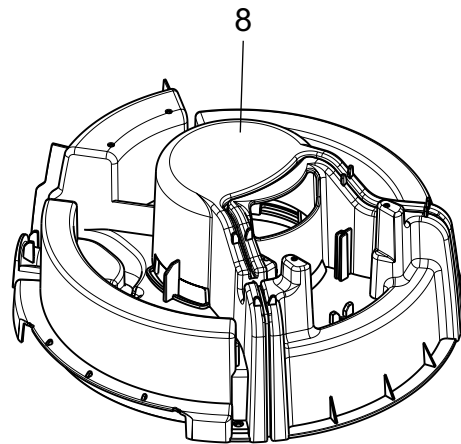
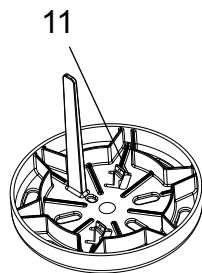
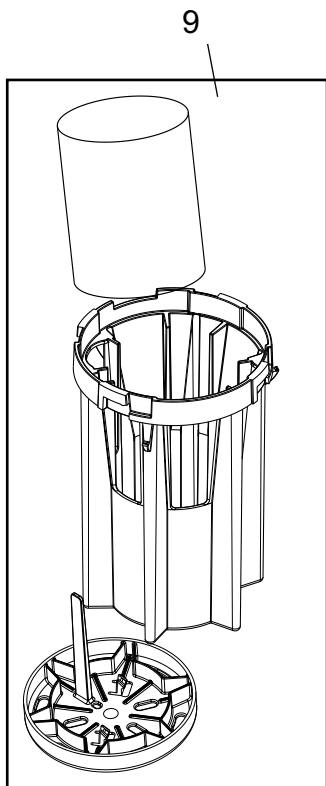
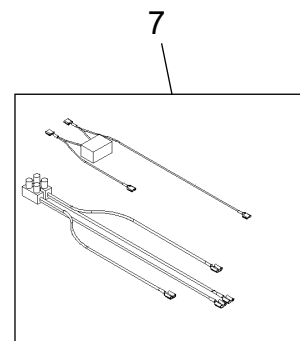
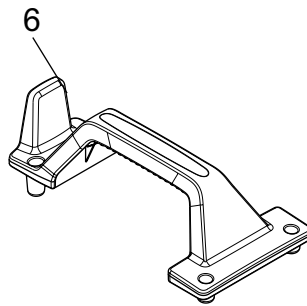
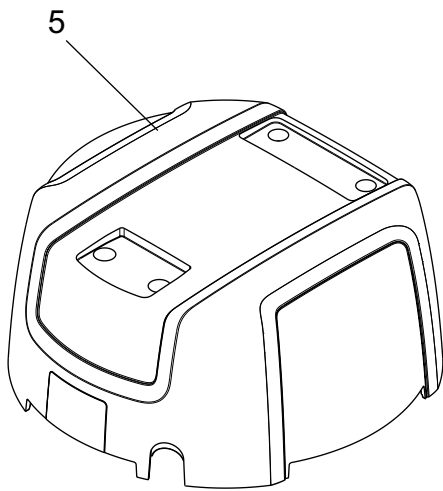
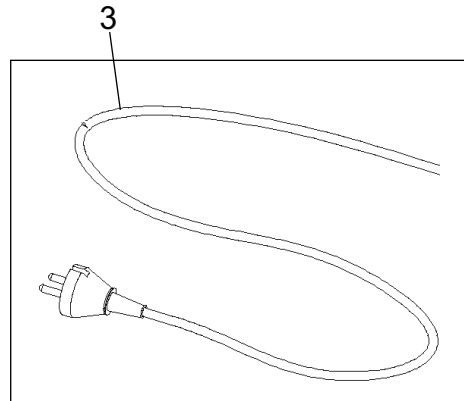
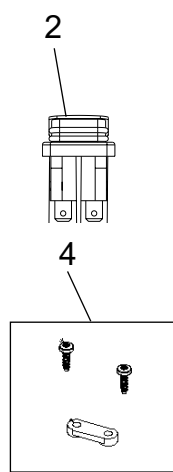
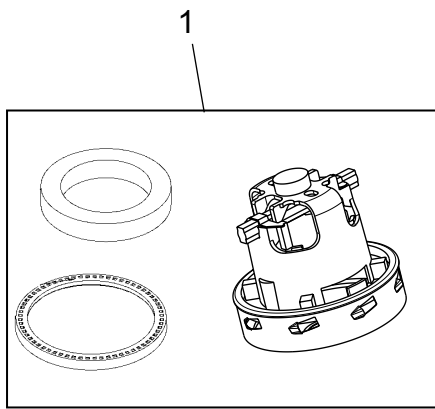

06-10**MOTOR TOP****823 0078 030****07-03****EWD 315, EWD 320, EWD 215, EWD 260****3**

Item.No.	Part No.	Qty.	Description	Note
1	140 8689 510	1	Fan unit By-pass 100-120V	Gaskets included.
2	140 9537 500	2	Switch two pole	
3	147 0716 500	1	Cord set grounded 50 feet (15,5 meter)	
4	140 6560 500	1	Anti strain clip	Screws included.
5	140 8668 520	1	Cover outer, UL-approved	Screws included.
6	140 8651 510	1	Handle	Screws included.
7	140 7620 510	1	Internal wires, UL-approved	
8	140 8653 510	1	Cover fan unit, UL-approved	
9	>>140 8680 500	1	Float basket	Valve and adapter.
10	140 8664 520	1	Chassis, UL-approved	
11	>> 147 1119 500	1	Adapter for float basket	Wear protection for main filter.

>>Means: New or changed ref. number or/and changed/new specifications.

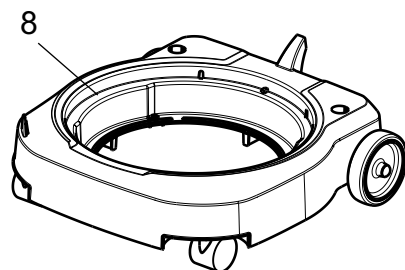
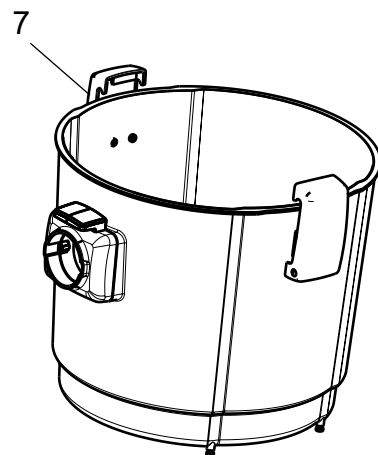
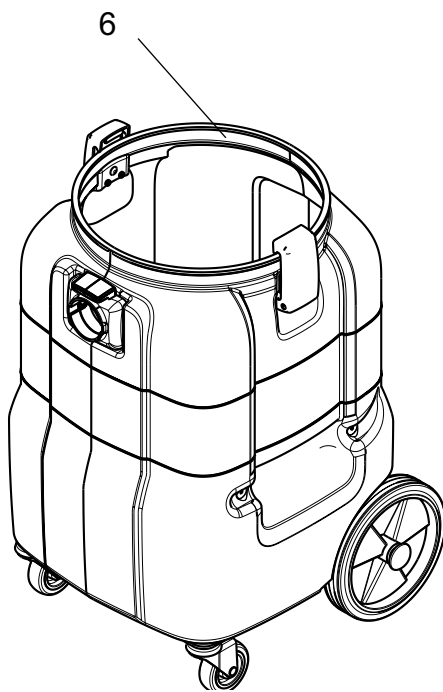
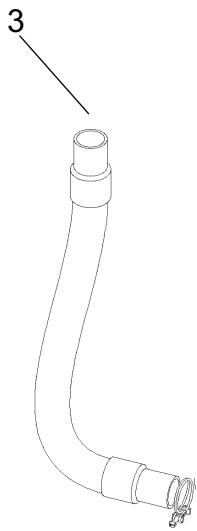
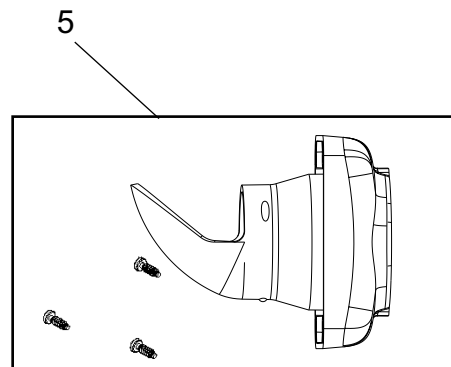
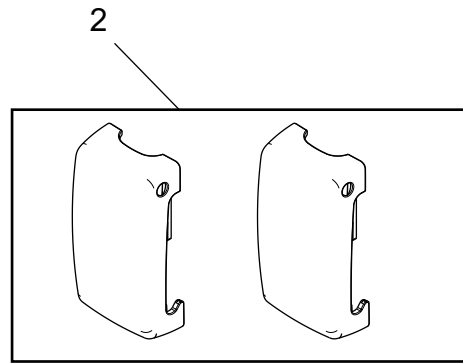
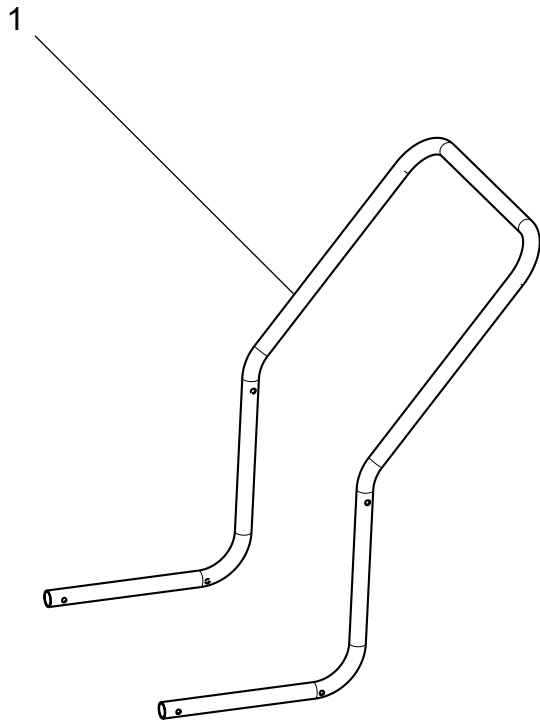

04-11**CONTAINER****823 0078 030****07-03****EWD 315, EWD 320, EWD 215, EWD 260****5**

Item.No.	Part No.	Qty.	Description	Note
1	147 0712 500	1	Handle cpl.	Screws included.
2	140 8691 500	2	Latches	Screws included.
3	140 7604 510	1	Hose	
5	140 7204 500	1	Inlet	Screws and trigger included.
6	140 9554 500	1	Container 12 Gallon	Complete container with wheels.
6	147 0713 500	1	Container 16 Gallon	Complete container with wheels.
7	>>140 8661 040	1	Container 20 L	For EWD 215. Latches included
8	>>140 8662 500	1	Frame trolley 20 L	For EWD 215.

>>Means: New or changed ref. number or/and changed/new specifications.

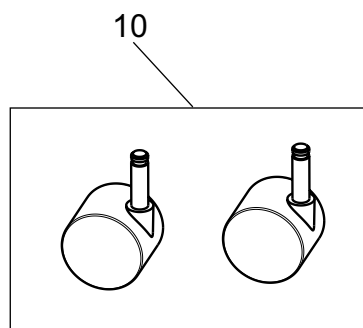
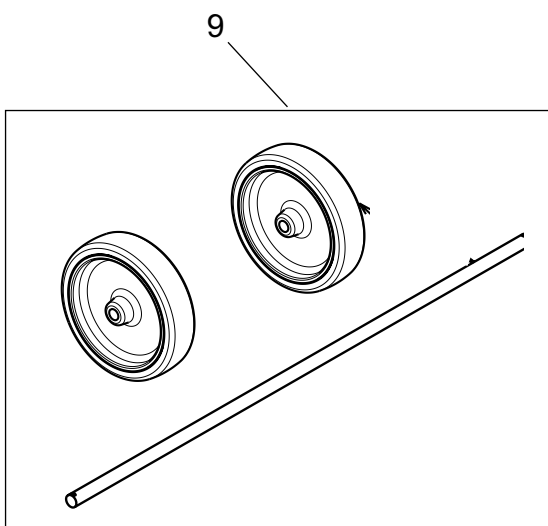
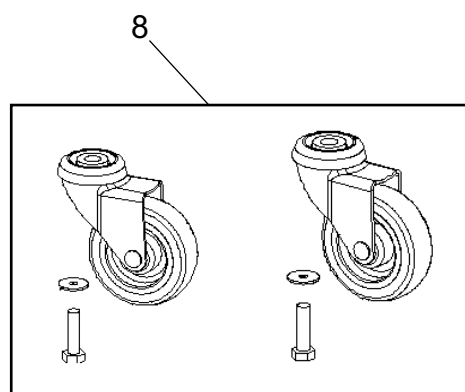
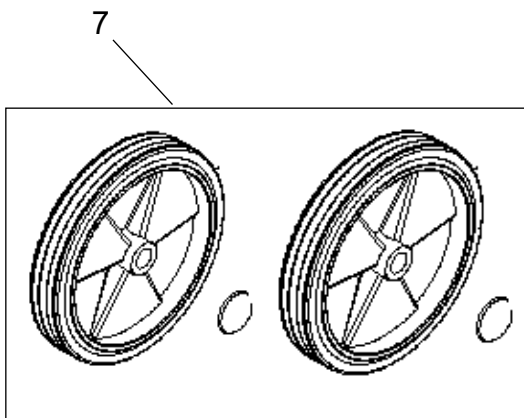
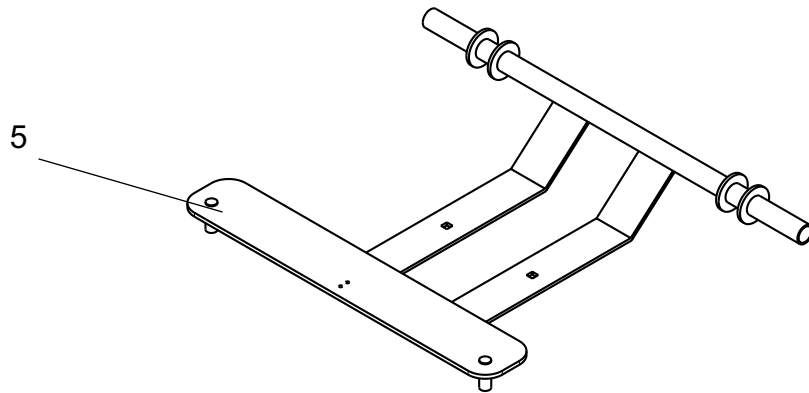

05-04**WHEELS****823 0078 030****07-03****EWD 315, EWD 320, EWD 215, EWD 260****7**

<u>Item.No.</u>	<u>Part No.</u>	<u>Qty.</u>	<u>Description</u>	<u>Note</u>
5	140 9553 500	1	Bracket plate for trolley	Screws and nuts included. For EWD 315, 320, 260.
7	140 9543 500	2	Wheel Ø 8.0 in (200 mm)	For EWD 315, 320, 260.
8	140 5476 520	2	Castor wheels	Screws and washers included. For EWD 315, 320, 260.
9	>>140 8446 600	2	Wheels rear, EWD 215	2 wheels, shaft included
10	>>140 6422 500	2	Castor wheels, EWD 215	Ø 2.0 in (50 mm) 2 wheels

>>Means: New or changed ref. number or/and changed/new specifications.

8

EWD 315, EWD 320, EWD 215, EWD 260

1

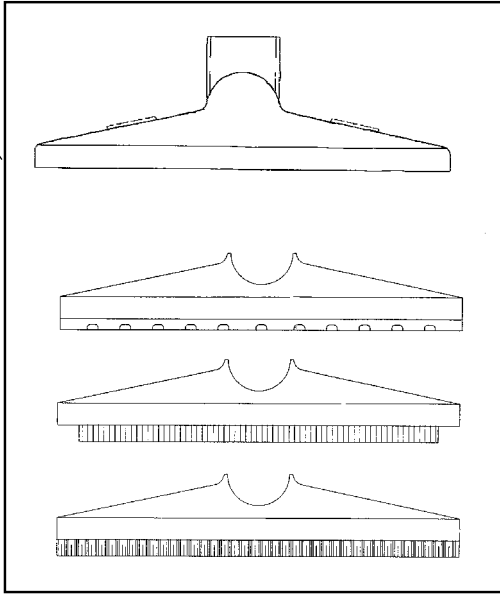

3

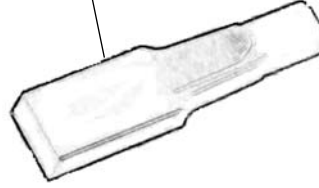

2

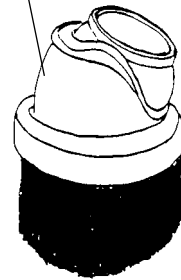

4

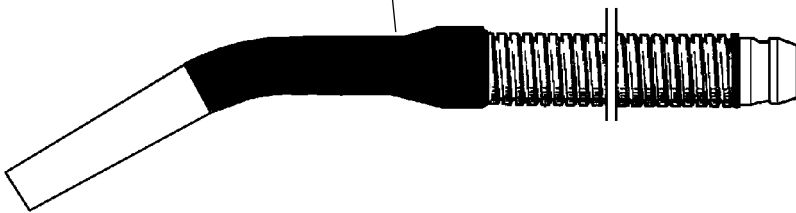

5

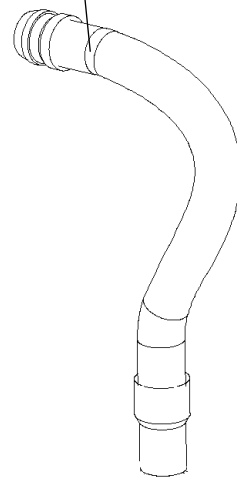

7

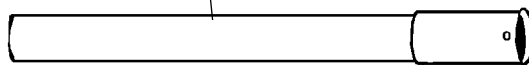

05-01**NOZZLES AND HOSES****823 0078 030****EWD 315, EWD 320, EWD 215, EWD 260****9**

Item.No.	Part No.	Qty.	Description	Note
1	140 8248 040	1	Universal nozzle, Ø 1.50 in	Complete with rubber stips, brush strips and carpet insert.
2	010 7031 000	1	Brush nozzle Ø 1.50 in	Optional.
3	140 8258 000	1	Crevice nozzle Ø 1.50 in	Optional.
4	140 4001 010	1	Hose complete with handle	Mat.: Plastic hose Ø 1.50 in Snap in coupling.
5	140 2148 500	1	Hose, Ø 1.50 in 1 1/2 ", 500mm	Hose for front nozzle.
7	011 6451 010	1	Extension tube Aluminium	Ø 1.50 in L= 19.68 in (500 mm).

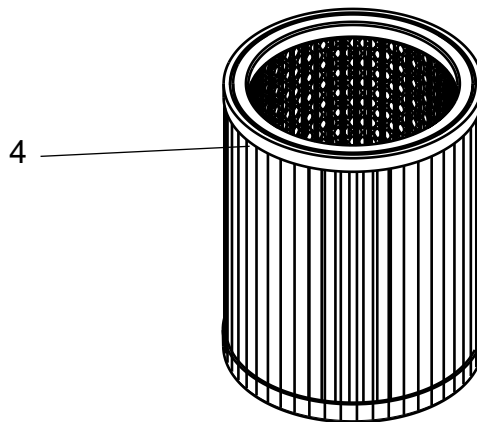
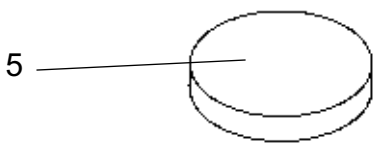
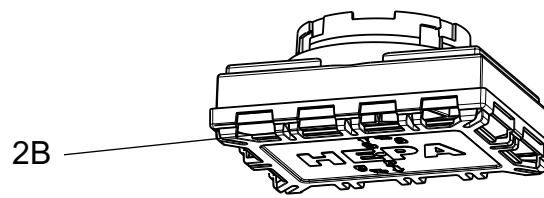
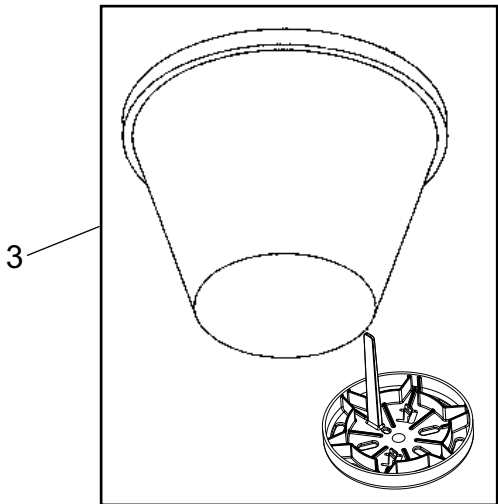
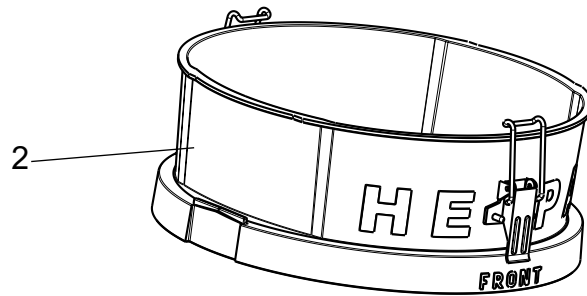
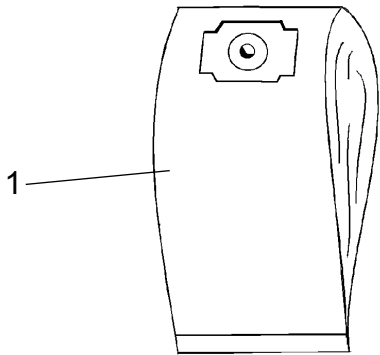

06-10**FILTERS AND DUST BAGS****823 0078 030****07-03****EWD 315, EWD 320, EWD 215, EWD 260****11**

Item.No.	Part No.	Qty.	Description	Note
1	147 0746 010	3	Dust bags	3-pcs. For EWD 315, 320, 260.
1	>> 147 0745 010	3	Dust bags	3 pcs. For EWD 215.
2	147 0766 500	1	HEPA-Protection Ring	For all models.
2B	140 8678 500	1	Filter HEPA	For all models.
3	>>140 8658 500	1	Main filter	With adapter for float basket.
4	140 8686 500	1	Filter Cartridge	For all models.
5	140 8682 500	1	Filter motor	For all models.

>>Means: New or changed ref. number or/and changed/new specifications.

