

# Trash / Recycle / Compost Lids

## LID ATTACHMENTS FOR 16, 18, 21 GALLON RECTANGULAR OPEN TOP BINS

Make it easy to sort trash, recycling, and compost quickly and cleanly in high-traffic venues like cafeterias, lobbies, kitchens, stores, and more. Paired with a HLS Commercial 16, 18, or 21 Gallon Stainless Steel Rectangular Open Top bin, the lid features a push button release for easy access. The universally recognizable color-coding and decal clearly mark the bin for separate trash, recyclables, and compostables.

**LIDROTRS**



**LIDROREC**



**LIDROCOP**



## FEATURES

- ✓ INCLUDES TRASH, RECYCLE, AND COMPOST DECALS
- ✓ PUSH BUTTON OPEN FOR QUICK AND EASY ACCESS
- ✓ COMPATIBLE WITH HLS16UOT / HLS18UOT / HLS21UOT TRASH BINS

# SPECIFICATIONS

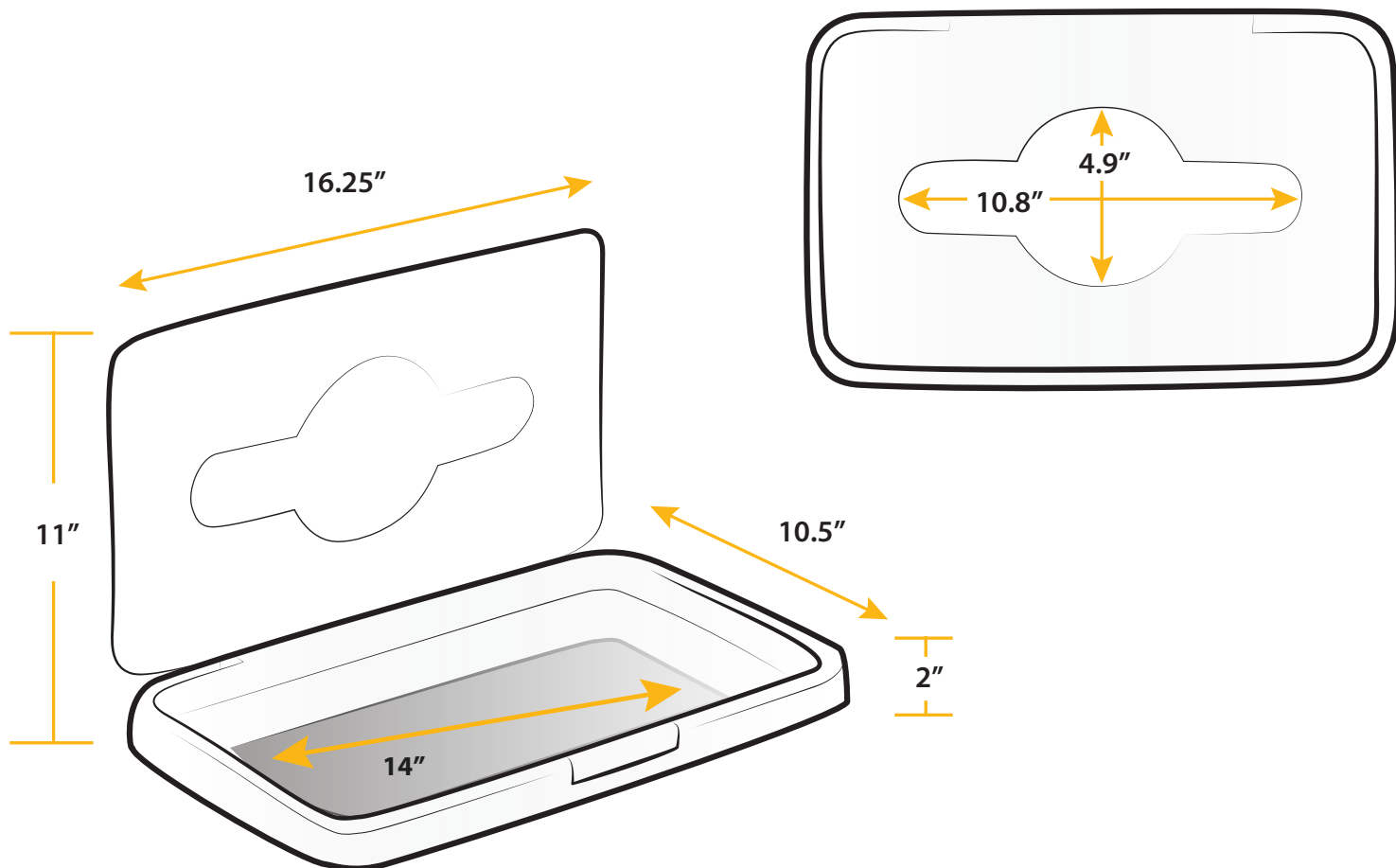

**Model:** LIDROTRIS / LIDROREC / LIDROCOP

**Dimensions:** 10.5" L x 16.25" W x 2" H

**Package Dimensions:** 12" L x 17.9" W x 3.4" H

**Product Weight:** .9 lbs.

**Package Weight:** 1.52 lbs.

**Material:** ABS Plastic