

**MADE  
IN THE USA**

\* Imported

**Companion Products (each sold separately):**

- KS123-0529: Infection Prevention Station
- SN003-0212: Sign Holder (shown below)

**Product Description:**

- Hand Sanitizer Floor Stand
- Standard back plate for use with hand sanitizer, hand lotion, or foam dispensers
- No tools required to assemble
- Self-righting base, up to 40 degrees past center without dispenser
- Bay Gray Powder-Coated Metal back plate, column, and base
- Quartz Beige ABS Plastic drip tray
- Back plate and drip tray made in the USA
- Column and base made in China

**Primary Area for Product Usage:**

- Anywhere hand sanitizing products are needed

**Package Specifications:**

- 20"L x 4"W x 20"H (50.8 cm x 10.2 cm x 50.8 cm)
- 18.0 lbs (8.2 kg) - approximated

**Product Specifications (overall external dimensions):**

- 18.00"W x 54.73"H x 18.00"D (45.7 cm x 139.0 cm x 45.7 cm)
- 16.3 lbs (7.4 kg) - approximated

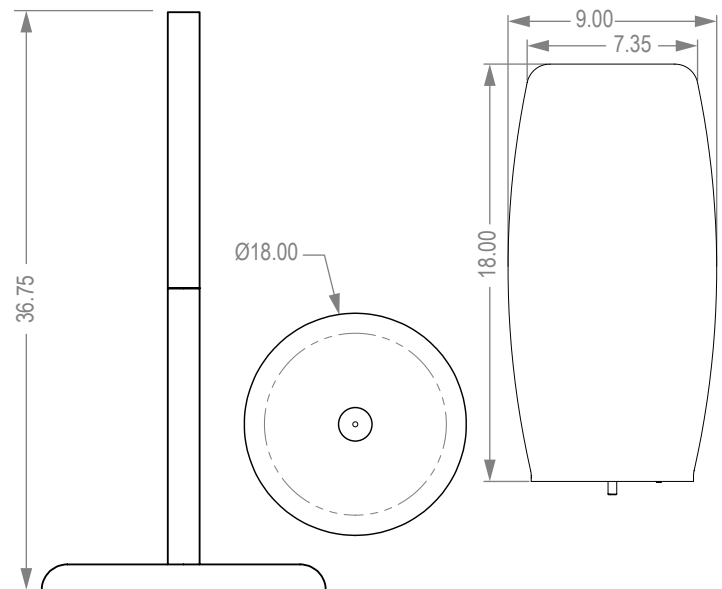
**Mounting Specifications:**



## Installation

Always mount dispensers securely *prior* to loading with product.

- To secure base to column, place base on floor, line up threaded stud on base with threaded hole in pole. Turn pole clockwise until tight.
- Screw the threaded hole of second pole section onto the stud in the top of the first section. Turn clockwise until tight.

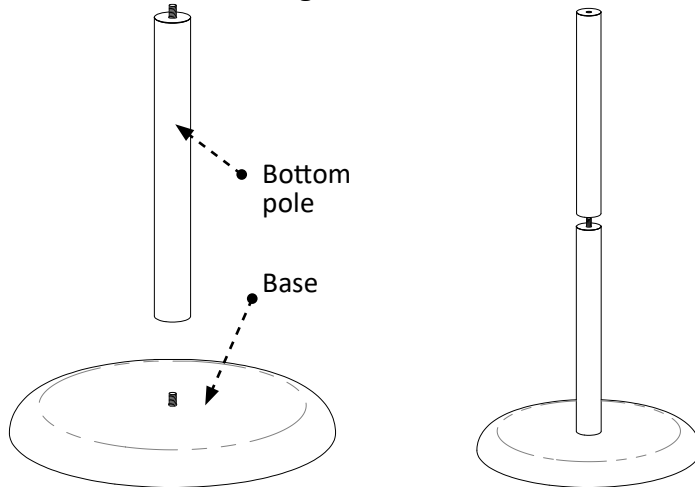
**1**

- Place hole in drip tray over stud from second pole section.
- Holding back plate upright, screw onto threaded stud.
- When attaching back plate, double check that drip tray is aligned with front of back plate as shown.
- Turn drip tray and back plate together for last few turns to tighten.

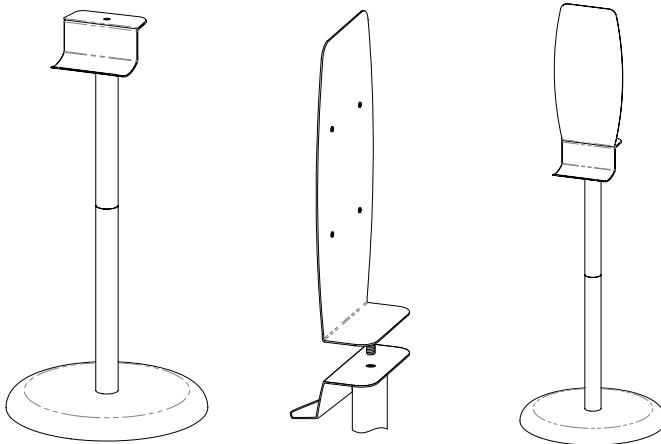
**2****Parts included:**

- Base, Column and Back Plate

**Tools Required:**

- No tools required to assemble dispenser

## Care and Construction

Powder-Coated Steel

### Material Characteristics

#### Designed for Long-Term, Heavy-Duty Applications

Dispensers and stands made of powder coated steel are both attractive and functional, providing years of service. Our powder coated steel dispensers and stands provide long-lasting products that hold up well in tough environments.

Powder coated steel is ideal for dispensers used in a healthcare or an industrial setting. It is impact resistant and is not effected by extremes in temperature.

### Care and Cleaning

The powder coated finish resists common chemicals and cleaning agents and can be easily wiped clean with soap and water.